

### Small Parts Schematics

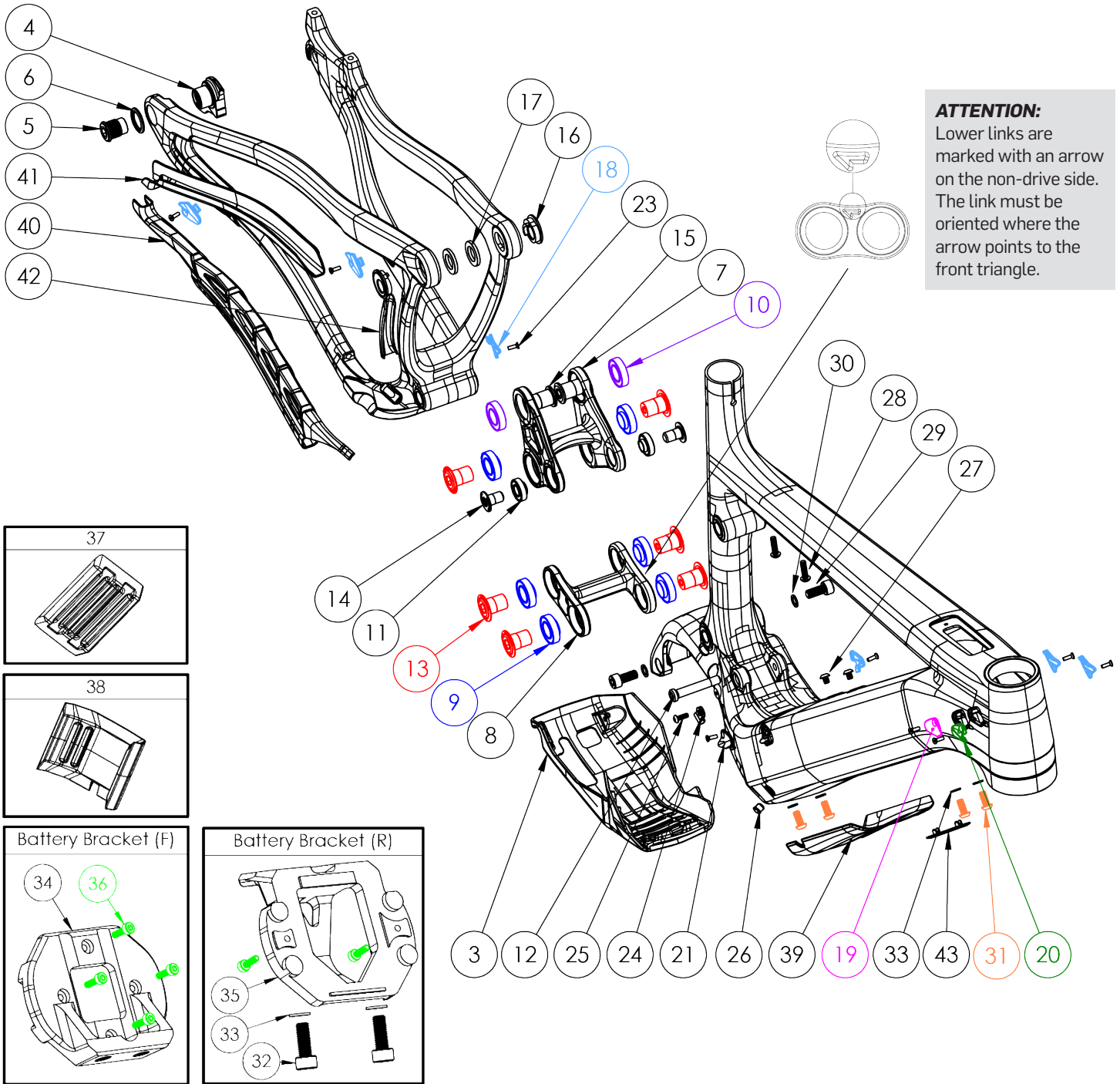

**ATTENTION:**  
Lower links are marked with an arrow on the non-drive side. The link must be oriented where the arrow points to the front triangle.

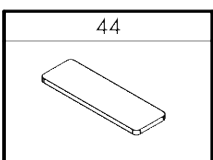

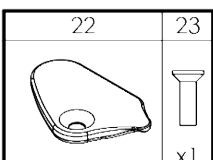
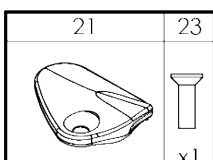
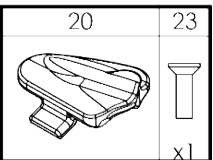
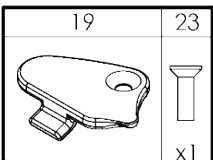
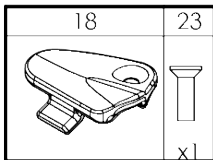
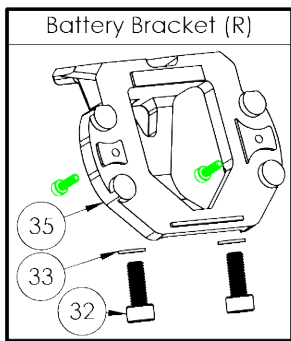
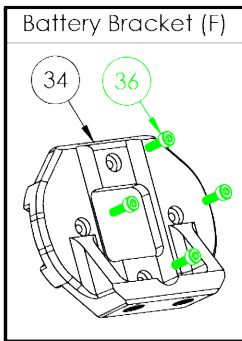
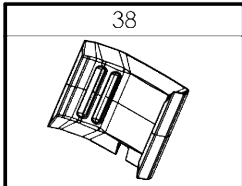
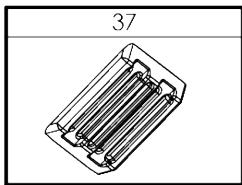

Hardware				
NUMBER	PART NUMBER	DESCRIPTION	TORQUE	*
3	FP-CVR-SKIDPLT-SHTV6-V1-R1	Shuttle V6 Skid Plate		
4	FP-UDH-TA-12MM-BLK-V1-R1	Universal Rear Derailleur Hanger		
5	-	Universal Rear Derailleur Hanger Bolt	25 Nm (18 lb-ft)	
6	-	Universal Rear Derailleur Hanger Washer		
7	FP-LNK-UL-68MM-V1-R1	68mm Upper Link		
8	FP-LNK-LL-50MM-V3-R1	50mm Out-to-Out Lower Link V3		
9	FP-BRG-6902-LLUMAXECN	28mm 6902 Extended Max-E Bearing		
10	FP-BRG-6902-LLUMAX	28mm 6902 Standard Max Bearing		
11	FP-BRG-6900-LLUMAXE	22mm 6900 Ext'd Max-E Bearing		
12	FP-BLT-M8*45.7-BLK-V2	M8 Front Shock Bolt for 30.1mm Shock Spacing	13 Nm (10 lb-ft)	G / L
13	FP-BLT-M14*20-BLK-V2-R2	M14x20 Link Bolt	35 Nm (27 lb-ft)	L
14	FP-BLT-M10*16.5-BLK-V1	M10 Trunnion Mount Bolt	13 Nm (10 lb-ft)	L
15	FP-BLT-M14*20-BLK-V3-R2	M14x20 Flip Chip Bolt	35 Nm (27 lb-ft)	L
16	FP-NUT-FLIPCHIP-4.6MM-V1	4.6mm Flip Chip		
17	FP-WSH-SPC-15I*250*3W	M14x3mm Flip Chip Spacer		
18	FP-CLM-MECH-FRM-V1	Internal Routing Cable Clamp		
19	FP-CVR-MECH-FRM-V2	Internal Routing Hole Cover		
20	FP-CLM-DUAL-FRM-V1	Internal Routing Dual Clamp		
21	FP-CLM-MECH-FRM-V2	Internal Routing Cable Clamp (Mirrored)		
22	FP-CVR-MECH-FRM-V4	Internal Routing Cable Cap (Mirrored)		
23	FP-SCW-FLT-M3*10-BLK	CABLE PORT CLAMP SCREW BLACK		
24	FP-CLM-ADEL-V1-R1	Cable Routing Adel Clamp		
25	FP-SCW-BTN-M4*12-BLK-V1-R1	M4x12 Adel Clamp Mounting Bolt		
26	FP-PLG-DI2-7*8*5	7x8mm Di2 Plug Ext'd		
27	FP-BLT-BTN-M5*6-V1-R1	M5x6 DT Water Bottle Bolts	3 Nm (26 in-lb)	L
28	PIVOT WB BOLTS V2	Top Tube Tool Bolts		
29	FP-SCW-SCK-M8*18-R1-BLK	M8X18 SOCKET HEAD SCREW BLACK	13 Nm (10 lb-ft)	L
30	FP-WSH-8I*120*1W-BLK	M8 WASHER BLACK		
31	FP-SCW-BTN-M6*14-BLK-V1-R1	M6x14 Front Bracket/Skid Plate Bolts		
32	FP-SCW-SCK-M6*16-BLK-V1-R1	M6x16 Rear Bracket Bolts		
33	FP-WSH-M6-BLK-V1-R1	M6 Washer Black		
34	FP-MNT-FRNT-BATT-SLTV2-V1-R1	Front Battery Bracket		
35	FP-MNT-REAR-BATT-SLTV2-V1-R1	Rear Battery Bracket		
36	FP-BLT-SCK-M3*10-V1-R1	Battery Mounting Bolts		
37	FP-BATT-PAD-60*70-V1-R1	Upper Battery Pad		
38	FP-BATT-PAD-LWR-87.3MM-V1-R1	Lower Battery Pad		
39	FP-PRO-SHTV6-DT-V1-R1	SHTLv6 Downtube Protector		
40	FP-PRO-SHTV6-CS-V1-R1	SHTLv6 Chainstay Protector		
41	FP-PRO-SHTV6-SS-V1-R1	SHTLv6 Seatstay Protector		
42	FP-PRO-SHTV6-UR-V1-R1	SHTLv6 Upright Protector		
43	FP-PRO-LL-50MM-V3-R1	Lower Link Protector		
44	-	Frame Size Sticker		
Axles				
NUMBER	PART NUMBER	DESCRIPTION	TORQUE	*
101	157MM THROUGH AXLE V5	157mm UDH Rear Axle	15 Nm (11 lb-ft)	G
Bike Care				
*	PRODUCT TYPE	RECOMMENDED PRODUCT	TORQUE	*
G	Grease	Motorex Bike Grease 2000		
L	Thread Locker**	Loctite Thread Locker #243 (or equivalent)		
G/L	Grease (Bolt Shaft) Thread Locker (Bolt Threads)	See Above	25 Nm (18 lb-ft)	
A	Anti-Seize	Motorex Copper Paste		
R	Retaining Compound	Loctite Retaining Compound #620 (or equivalent)		

\*\*Threadlocker should always be applied to the corresponding female threads for the bolt specified

